

REV. A

MODEL: S4581G-□□1  
X Y

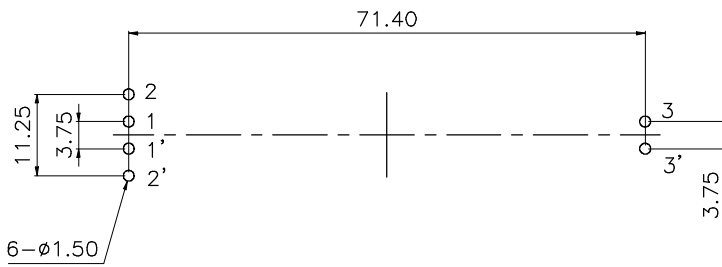
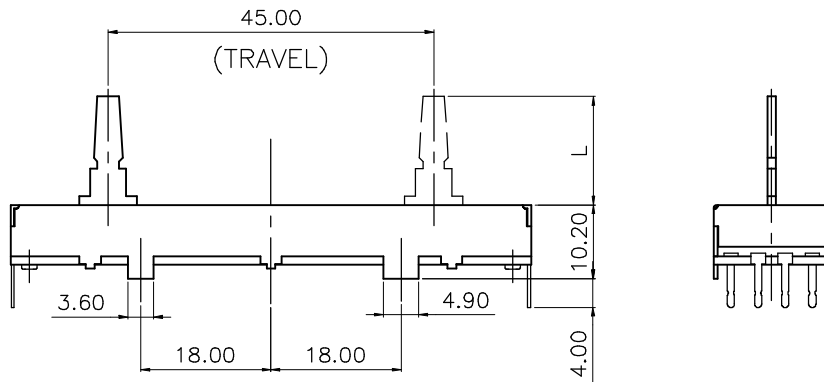
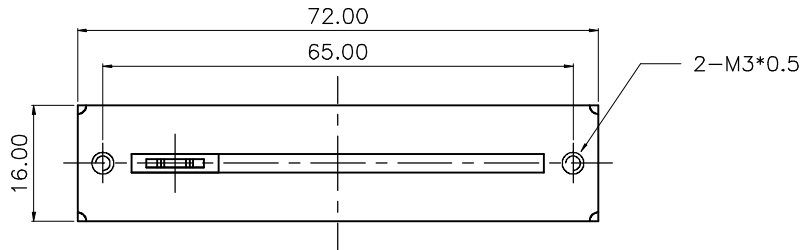

TYPE	P.C.B Type				Solder Lug Type			
Y	A				B			
DIMENSIONS								
	H	1			H	1		
		4.0				4.0		

REV. A

MODEL: S □□ 81/82/83G

Metal lever (金屬柄)

LEVER TYPE	CH					D				
DIMENSIONS										
	X	1	4			X	X	Y	Z	W
LENGTH(L)	L	10.0	20.0			L	15.0	20.0	16.5	12.0
						H	13.8	13.8	15.3	10.8

LEVER TYPE	B					B1				
DIMENSIONS										
	X	J				X	L	M	N	O
LENGTH(L)	L	15.0				L	8.0	10.0	12.0	20.0
						phi A	phi 1.5	phi 1.5	phi 1.5	phi 1.5

LEVER TYPE	H				
DIMENSIONS					
	X	R			
LENGTH(L)	L	8.0			

# MODEL: S□□81G

Mechanical characteristics:機械的性能:

Item<項目>	Performance<性能>
Travel 行程	45、60、100mm
Operating force 作動力	10~150 gf-cm
stopper strength 作動停止強度	10Kgf/60 sec Measuring point: 10mm for travel 45~100mm
Push-pull strength 軸推拉強度	5 kgf (Max at 10 sec)

Electrical characteristics:電氣的性能:

Item<項目>	Performance<性能>
Resistance taper 阻值線性	A/B/C

**Reference:** Standard resistance tapers in reference to rotational angles(travel) are as shown below:

**參考:**標準阻值曲線及旋轉角度(行程)表示如下:

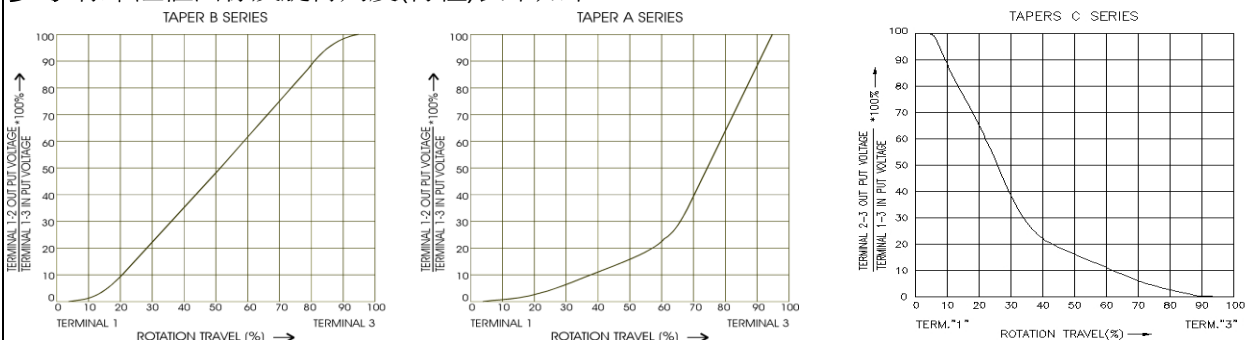

Total resistance 總阻值	1KΩ~1MΩ
Total resistance tolerance 總阻值容許差	±20% (more than 1MΩ±30%)
Max. operating voltage 最高使用電壓	B curve:100V Other than curve B:50V
Rated power 定格電力	B curve: 0.1W Other than curve B: 0.05W
Residual resistance 殘留阻值	$R \geq 250K\Omega$ 0.1% max. of total resistance $250K\Omega > R > 10K\Omega$ 20Ω max. $10K\Omega \geq R$ 10Ω max.
Sliding noise 滑動雜音	Less than 100mV
Insulation resistance 絕緣抵抗	More than 100MΩ at DC 250V
Manual Soldering heat 手焊錫溫度	Below 300°C, Less than 3 seconds.
Gang error 相互偏差(同步)	-40 to 0dB dB ≤ 3dB

Durability:耐久的性能:

Item<項目>	Performance<性能>
Sliding life 滑動壽命	15,000 cycles